

# DIRECTORY

OF

## The Greenbrier and Cottages White Sulphur Springs, W. Va.



*"America's Most Beautiful  
All-Year Resort"*

General Manager.....	L. R. JOHNSTON
Assistant Manager.....	GEORGE D. O'BRIEN
Assistant to General Manager.....	R. B. PARKER
Chief Night Clerk.....	RUSSELL SIBOLD
Medical Director.....	DR. GUY HINSDALE
Resident Physician.....	DR. GEORGE M. CALDWELL
Maitre d'Hotel.....	JOSEPH REISER
Chef.....	ERNEST SCHLEUSSENER
Housekeeper.....	MISS MARIE F. HARRINGTON
Head Porter.....	JOHN DINEEN
Head Bellman.....	JIM MCKENZIE
Manager Water Department.....	WILLIAM PERRY
Manager Golf Club.....	FRED MARTIN
Consulting Engineer.....	R. H. PATTERSON

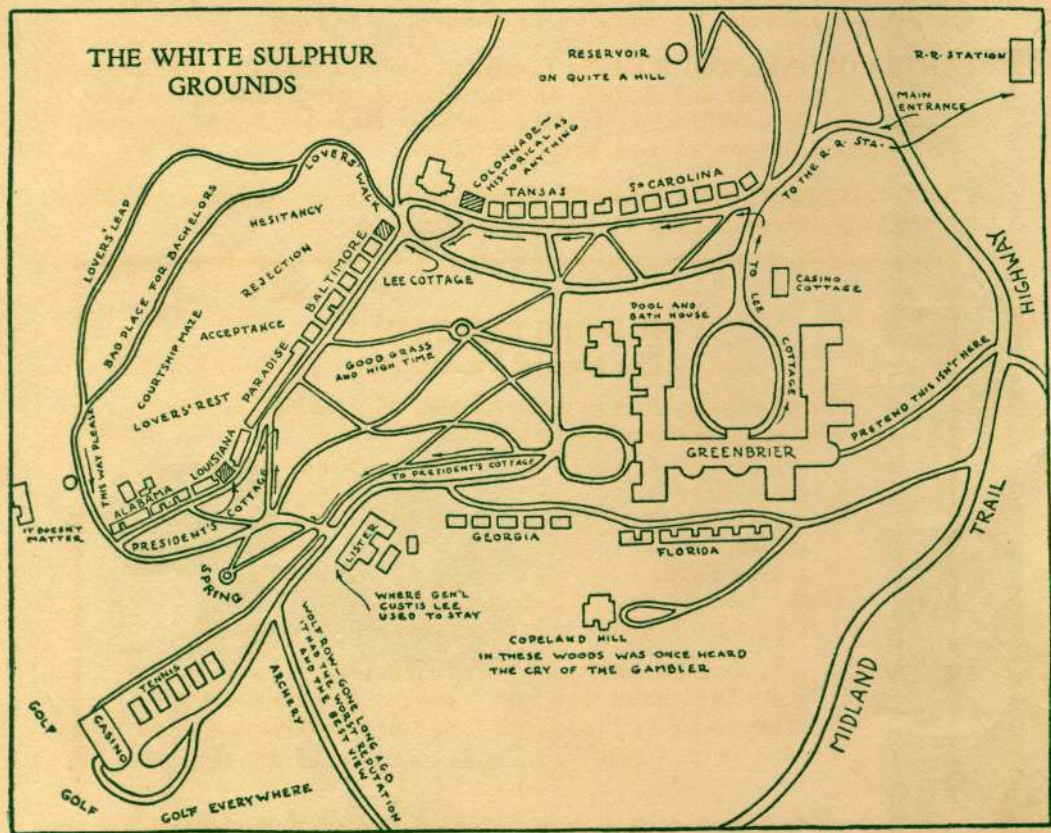

## Notice to Guests

A safe is provided in the office of this hotel for the deposit and safe-keeping of all Money, Jewels, Ornaments, or other valuable articles of small compass belonging to its guests.

Unless so deposited the Management will not be liable for the loss thereof.

White Sulphur Springs, Inc.

### A

**AIRPORT:** Within two miles of Greenbrier. Charter plane service and local sight-seeing trips. Gas and oil service throughout year. All-metal hangar. For complete information and reservations telephone Charles O. Tate, Jr. and Carlton C. Clark. Telephone numbers: Greenbrier Hotel, 307; White Sulphur Springs, 7; Night or Emergency Calls, White Sulphur Springs, 232.

**ANTIQUES:** Shop floor. Antique furniture, silver, jewelry and prints. Mrs. Kay Bolger.

**ARCHERY:** Outdoor range, near tennis courts. Inquire at tennis club Spring, Summer and Fall. No charge for equipment or use of range.

**ARTS COLONY, "Old White":** Located in Alabama and Louisiana Cottage rows. Open July and August. Instruction in drawing, painting, ceramics. Mr. and Mrs. William C. Grauer, directors. Rates are \$30.00 per week, per person, inclusive of room, board and tuition.

**ART GALLERY, "Old White":** Exhibitions of modern American painting, etchings, lithographs, etc. Adjoining ballroom, lobby floor.

## THE BATHS DEPARTMENT

(See Medical Department)

The Greenbrier offers to guests an unexcelled bathing equipment and other means of physiotherapy including:

SULPHUR BATHS

CABINET BATHS

NAUHEIM BATHS

FOAM BATHS

PARAFFIN PACKS

SCHELLBERG SYSTEM OF COLONIC THERAPY

EXPERIENCED MASSEURS, TECHNICIANS AND ATTENDANTS

STEAM ROOM

MUD PACKS

LIGHT BATHS

ULTRA VIOLET

INFRA-RED

Baths given by appointment only. Call Men's Baths or Women's Baths. Baths Department open from 8 a. m. to 12 noon and 3 p. m. to 6 p. m. on week days, Spring, Summer, Fall and Winter; open on Sundays 8 a. m. to 12 noon.

## B

**BADMINTON COURT:** Outdoor courts at Golf and Tennis Club, Spring, Summer and Fall. No charge for court use.

**BARBER SHOP:** Frechem's. Shop floor. Open in Spring, Summer and Fall. Week-day hours 8 a. m. to 6:30 p. m.; Winter, open 9:00 a. m. to 5:00 p. m. Sundays, 9 a. m. to 12 noon.

**BEAUTY SHOP:** Frechem's. Shop floor. Open on week days from 9 a. m. to 6 p. m., Spring, Summer and Fall; Winter, 9 a. m. to 5 p. m. Closed on Sundays.

**BOTTLING PLANT:** Shop floor, outside facade, north wing. The public is invited to inspect this modern plant where Greenbrier Sparkling Water and Greenbrier Ginger Ale are bottled.

**BRIDGE:** Ask bell boy for tables.

**BROKERAGE OFFICE:** Shop floor. Branch office of Harris, Upham and Co.

## C

**CANDY SHOP:** Cordwood Cabin. Shop floor. Mrs. Frank Harris.

**CASINO-CLUBHOUSE:** Luncheon and dancing in the Tangerine Room or on the Terrace. Men's Grill on lower floor. Checks may be signed. Open April to November. A la carte and table d'hote service. Table d'hote luncheon served 12:00 to 2:30 p. m.; a la carte service 12 to 6 p. m. Men's Grill downstairs same hours.

**CHESAPEAKE & OHIO LINES:** Ticket office on shop floor. Mr. C. W. Thompson, ticket agent.

**CHILDREN:** Kiddies' Klub Room. For those rainy days. Next to swimming pool.

**CHILDREN'S SHOP:** Shop floor. Mrs. Edith Humphrey.

**CHURCHES:** Inquire at Front Desk for day and hour of services.  
St. Charles Catholic Church.....Rev. Father Patrick Browne, Pastor  
St. Thomas Episcopal Church.....Rev. Ben R. Roller, Pastor  
Emmanuel Methodist Church.....Rev. Frank A. Settle, Pastor  
First Presbyterian Church.....Rev. Don R. Brandon, Pastor

**CIGAR STAND:** Main Dining Room—also Drug Store.

**COTTAGES:** Alabama, Baltimore, Florida, Georgia, Paradise, South Carolina, Louisiana, Tansas Rows. Casino, Colonnades, Hawley, President's and Stevens Cottages. Housekeeping and Non-Housekeeping. Special Summer Season Family rates upon request. Cottages available Spring, Summer and Fall.

**CROQUET:** Adjoining tennis courts and North Lawn. No charge.

## D

**DANCING:** Spring through Fall—dinner-dancing in the Colonnades, at the Casino during luncheon and in the Cameo Ballroom in the evening. Music by Meyer Davis Orchestra. Special holiday dances throughout Winter. Roy K. Petticord, dancing master, Spring to Autumn.

## DINING ROOM

The Greenbrier is operated on the European Plan. For the convenience of our patrons both A la Carte and Table d'Hote dining-room service are available. The Greenbrier has continental service in the dining room.

**Table d'Hote Service** in the main dining room is provided only during the following hours:

BREAKFAST . . . . . 7:30 to 10:30 a. m.

LUNCHEON . . . . . 12:00 to 2:30 p. m.

DINNER . . . . . 6:00 to 8:30 p. m.

**Table d'Hote Meals:** Summer and Winter Seasons—Breakfast, \$1.25; Luncheon, \$1.50; Dinner, \$2.25. Spring and Fall Seasons: Breakfast, \$1.50; Luncheon, \$1.75; Dinner, \$2.50. Club Breakfasts, 75c and \$1.00.

**A la Carte Service** is provided continuously throughout day and evening in the main dining room from 7:00 a. m. until closing.

**DENTIST:** Dr. C. O. Crank, Medical Department. Office hours: 8:30 a. m. to 5 p. m., Spring, Summer and Fall; Winter, 10 a. m. to 5 p. m. Sundays, all year, 9 to 10:30 a. m.

**DOCTOR:** George M. Caldwell, M. D., Resident Physician. Office hours: 9 to 1 p. m., 3 to 5 p. m. on week days, Spring, Summer, Fall and Winter. Sundays, 9 a. m. to 1 p. m. Also available upon call.

**DOLLHOUSE:** On way to Casino. Open Spring, Summer and Fall. Mrs. Pet Sullivan.

**DRESS SHOP, LADIES' SHOP:** Mme. Najla Mogabgab. Shop floor. Spring, Summer and Fall.

**DRUG STORE AND SODA FOUNTAIN:** Dr. G. B. Merriam. Shop floor. Open 8 a. m. to 10 p. m. daily and Sunday during Spring, Summer and Fall. Winter, open week days 8 a. m. to 1 p. m. and 4 p. m. to 8 p. m. Sundays in Winter, 8 a. m. to 1 p. m., 6 p. m. to 8 p. m.

## F

**FISHING:** Licenses during open seasons will be obtained by Private Office for guests wishing to fish in streams in State. There is no fishing or hunting allowed on the property.

**FLORIST:** K. M. Gillespie. Shop floor. Open 9 a. m. to 6 p. m. on week days, Spring, Summer and Fall; Winter, 9 a. m. to 5:30 p. m. Sundays, 9 a. m. to 12 noon.

## G

**GALLERY OF NOTABLES:** Photographs of famous visitors to The Greenbrier (to be inaugurated during 1940). "Old White" corridor, lobby floor, north wing (at ping-pong room).

**GAME ROOMS:** Indoor golf driving range, north wing facade, shop floor level. On lobby floor, north wing, pocket billiard table, ping-pong tables. Inquire at front desk for equipment.

**GARAGE:** Fireproof, individual stalls, adjoining hotel. Per day, \$1.00; per month, \$20.00. Open 24 hours each day, Spring, Summer, Fall, Winter.

**GIFT SHOP:** Foster and Reynolds. Shop floor.

**GOLF:** Three courses, all with grass greens, two of eighteen holes and one of nine. (One course available all year.) Practice putting green. Greens fees: Spring and Fall, \$2.50 per day, including Locker and Club Cleaning; Winter and Summer, \$2.00 per day, including locker. Special season rate, \$75.00. Golf professionals: Steve Gagan and Al McCoy.

**GOLF AND TENNIS CLUB:** (Casino-Clubhouse.) Five minutes' walk from north wing of hotel. Fred Martin, manager. Golf professionals, Steve Gagan and Al McCoy. Club has lockers, showers, men's grill, dining room, dining terrace, and dancing during luncheon, April through October.

## H

**HABERDASHER:** W. W. Buran. Shop floor. Men's clothing and furnishings.

**HALL OF GOVERNORS:** Adjoins dining room, lobby floor. Has fully equipped stage and public address system. Movie theater, meeting room, banquet hall.

**HORSESHOE RINK:** Opposite tennis courts.

**HUNTING:** Hunting licenses during open seasons may be obtained through the Private Office for use in State. There is no hunting or fishing allowed on The Greenbrier Estate, which is a preserve.

## WEST VIRGINIA STATE LIQUOR AGENCY

The State of West Virginia has placed an Agency for the sale of wines and liquors in The Greenbrier. **NO REVENUE WHATSOEVER ACCRUES TO THE HOTEL FROM SALES IN THIS AGENCY.** A corkage charge will be made on all wines served.

This agency is open from 10 a. m. to 9:30 p. m., Spring, Summer and Fall; Winter, from 10 a. m. to 12 noon and 6 p. m. to 7 p. m. daily, *except Sundays, holidays and all general and special election days.*

### I

**INFORMATION AND TRAVEL BUREAU:** Miss Edith Barry, manager. Shop floor. Open 9 a. m. to 5 p. m. on week days, Spring, Summer, Fall, Winter. Sundays, 9 a. m. to 12 noon.

### K

**KATE'S MOUNTAIN LODGE:** Southern cooked luncheons and dinners and afternoon teas *served on short notice by telephoning* Adolph Bittner, headwaiter, at the lodge. Open April through October. Steak and chicken dinners cooked deliciously, Southern style.

### L

**LABORATORY ANALYSIS DEPARTMENT:** Call Secretary of Medical Department, 9 a. m. to 5 p. m. week days or 9 a. m. to 12 noon on Sundays, Spring, Summer, Fall and Winter.

**LAUNDRY:** Guests' work done with especial care. One and two-day service. Call laundry. (Winter call Bell Stand.)

**LIBRARY:** Reference books only, just off main lobby. Rental library at Union News stand, shop floor.

**LINEN AND LINGERIE SHOP:** Greenbrier Linen Shop. Shop floor.

**LITERATURE:** Folders and rates of The Greenbrier will be sent gladly to any address furnished. Ask Front Desk for literature request card. Simply fill out and leave at desk.

**LUGGAGE:** Outgoing, call Porter's Office. Open daily and Sunday, 6:30 a. m. to 9 p. m., Spring, Summer and Fall. Winter, open daily and Sunday, 7 a. m. to 12 noon and 4 p. m. to 8 p. m.

PATRONS AND GUESTS wishing not to be disturbed in the early morning by Maids who are checking rooms, can do so by turning key on inside of door. The indicator shows on the outside and the door cannot be opened.

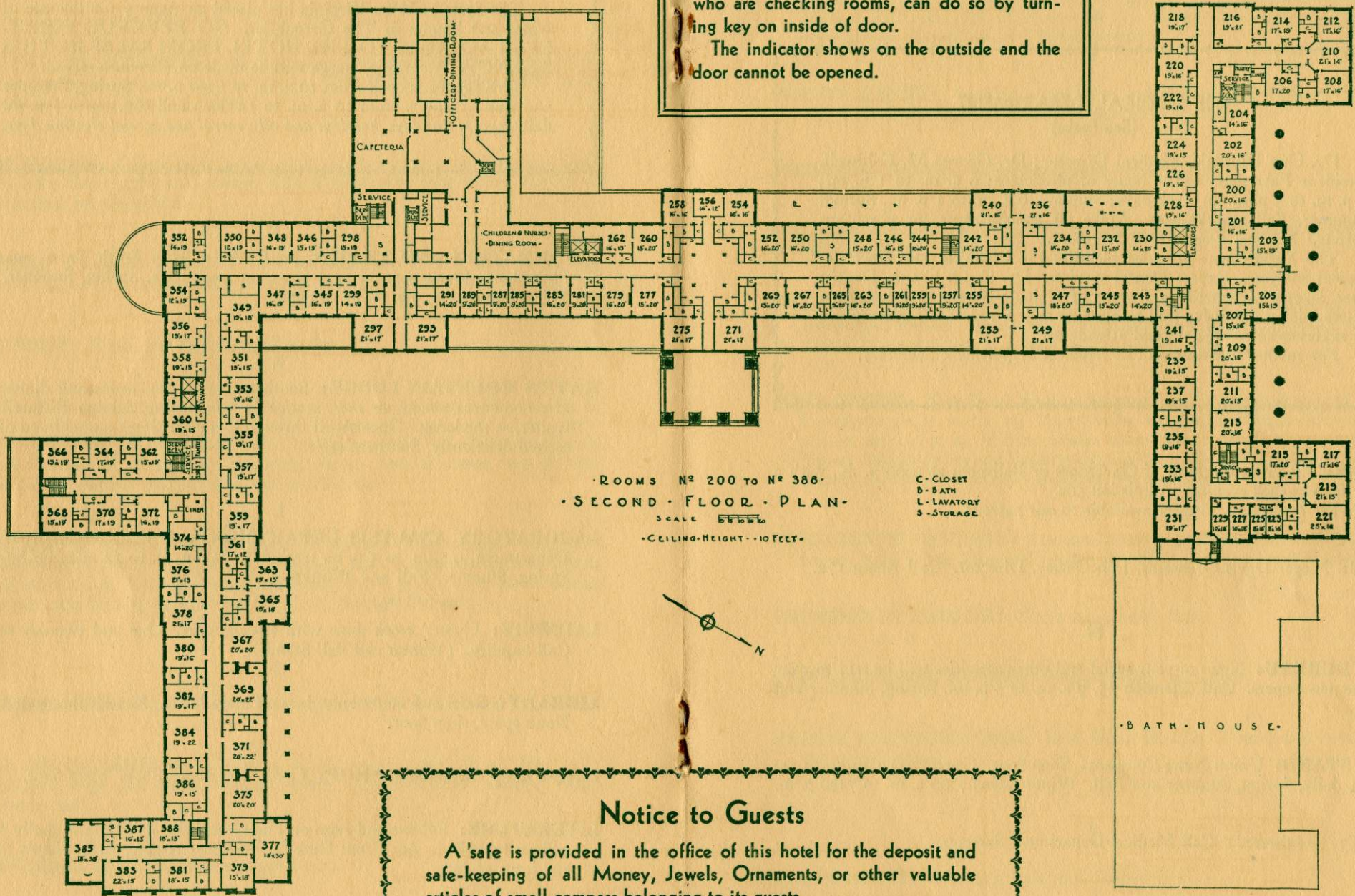

ROOMS N<sup>o</sup> 200 TO N<sup>o</sup> 388  
 SECOND FLOOR PLAN  
 SCALE 1/8" = 10'  
 CEILING HEIGHT - 10 FEET

**Notice to Guests**

A safe is provided in the office of this hotel for the deposit and safe-keeping of all Money, Jewels, Ornaments, or other valuable articles of small compass belonging to its guests. Unless so deposited the Management will not be liable for the loss thereof.

WHITE SULPHUR SPRINGS, Inc.



**LUNCHEON:** Casino Terrace, Casino Men's Grill, Kate's Mountain Lodge or Main Dining Room.

## M

### THE MEDICAL DEPARTMENT

(See Baths)

Dr. Guy Hinsdale, Medical Director; Dr. George M. Caldwell, Resident Physician. Office hours of physicians: 9 a. m. to 1 p. m.; 3 p. m. to 5 p. m. on week days; Sundays, 9 a. m. to 1 p. m., Spring, Summer, Fall and Winter. Make all appointments for physicians through Medical Department Secretary.

The Department provides facilities for Chemical and Bacteriological analyses. Expert Dental services. Dr. C. O. Crank, Dentist (*see Dentist*). Schellberg System of Colonic Therapy; Diathermy, Ultra-Violet and Infra-Red treatments and X-ray. Staff is composed of experienced technicians and attendants.

For further information call Medical Department Secretary.

**MOVIES:** Shown in the Hall of Governors or Ballroom at 9:00 p. m., with a new feature each evening. Admission 50c.  
16 MM. Projection Theater available to our patrons.

**MUSIC:** Meyer Davis Orchestra, Lon Chassy, Director. Call Room 172.

## N

**NEWS BUREAU:** News of your social and other activities will be sent to your home newspapers. Call extension 35, 9 a. m. to 5 p. m., Spring, Summer and Fall.

**NEWS STAND:** Union News Company. Shop floor. Open 7:00 a. m. to 11:00 p. m. daily, Spring, Summer and Fall. Winter, open 7:00 a. m. to 7:30 p. m.

**NURSE:** (Registered) Call Medical Department Secretary.

## O

**ORGAN ROOM:** Organ recitals daily with Nat Portnoff at the Moller console. Tea served in organ room during recitals at 4:30 p. m.

## P

**PARKING OF AUTOMOBILES:** We suggest that guests avail themselves of the facilities provided for storage by placing their car in our garage, charge for which is \$1.00 per day. It is our policy to charge \$1.00 for all cars parked overnight on the grounds of The Greenbrier.

**PHOTOGRAPHY:** Supplies, developing, portraiture, and cameras for rent. A. A. Cummins Studio. Shop floor, next to drug store.

**PING-PONG ROOM:** Lobby floor, north end of hotel.

**POLO-SKEET CLUBHOUSE:** 2 miles from hotel, lower end of airport. Polo field, also indoor practice cage.

**PORTER'S OFFICE:** John Dineen, head porter. Handle outgoing luggage. Hours open Spring, Summer and Fall: 6:30 a. m. to 9:00 p. m. daily. Winter, 7:00 a. m. to 12:00 noon and 4:00 p. m. to 8:00 p. m.

**POST OFFICE:** Shop floor. Spring, Summer and Fall week-day hours (closed Sundays): 9 a. m. to 7 p. m. Money order and Registry obtainable week days 9 a. m. to 3:45 p. m. Winter Season hours: 9 a. m. to 12 noon; 5 p. m. to 7 p. m. Money orders and Registry obtainable in Winter 9 a. m. to 11:45 a. m. Stamps also available at news stand and Front Office.

**PRESIDENTS' COTTAGE:** Summer Residence of three U. S. Presidents, now houses "Old White Museum"; guests invited to visit, inquire at Front Desk.

**PRESIDENTS' PARLOR:** North wing, lobby floor.

**PRIVATE DINING ROOMS:** Virginia wing, lobby floor.

**PUBLIC STENOGRAPHER:** Miss Edith Barry in Travel and Information Bureau, shop floor.

## R

**RADIO ROOM:** Adjoining Ballroom. Lobby floor.

**RAILROAD TICKET OFFICE:** Train and Pullman reservations. Shop floor. C. W. Thompson, ticket agent.

**RESERVATIONS:** Mr. George D. O'Brien, Assistant Manager, is in charge of all hotel and cottage reservations.

**RIDING:** Dickson Bros. Fine stable of saddle horses and hunters. Call Saddle Horse office, open 9 a. m. to 6 p. m. daily and Sunday, Spring, Summer and Fall. Winter, open 10 a. m. to 5 p. m. daily and Sunday. First hour \$3.00, each additional hour \$2.00. Mounting block at north entrance of Greenbrier.

## S

**SHOE SHINING:** Shop floor.

**SKEET:** Two skeet fields, one trapshooting layout, handsome clubhouse. Shooting arrangements by appointment only; \$1.50 per round of 25, inclusive of shells and targets. Guns available if desired.

**SKEET-POLO CLUBHOUSE:** Two miles from hotel, lower end of airport.

**SOLARIUM:** Atop Greenbrier. Call Medical Department.

**SPRING HOUSE:** On way to Casino. Alvon (mountain spring) water and Sulphur water on tap. Attendant, Spring through Fall.

**SPRING ROOM:** Adjoining Cameo Ballroom. Alvon, Sulphur, W. S. S., and Iron Chalybeate water. Attendant, Spring through Fall, from 8 a. m. to 12 noon and 8 p. m. to 12 midnight.

**STAMPS:** U. S. Post Office, shop floor. When Post Office is closed stamps may be obtained at Front Desk and Union News stand.

**SUN DECK:** On West Terrace, comfortable deck chairs. Blankets from Bell Stand.

**SUNTAN BATHING BEACH:** Adjoining swimming pool.

**SWIMMING POOL:** Open year around, 102 x 40 feet, filled with continuously flowing spring water. Per swim, 50c (includes locker). Special family summer membership rates. Hours open *Spring and Fall* on week days, 10 a. m. to 1 p. m. and 4 p. m. to 6 p. m.; Sundays, 10 a. m. to 1 p. m. *Summer*—open 10 a. m. to 6 p. m. daily and Sunday. *Winter*—open on week days 4 p. m. to 6 p. m.; Sundays, 3 p. m. to 5:30 p. m.

### TAXICABS

Service available 24 hours daily, year around. Call Motor Service. **TAXICABS MEET ALL TRAINS.** Transportation from and to railway station is placed on bill upon arrival.

#### RATES (per person, one way)

To Station.....	25c
To Golf and Tennis Clubhouse.....	25c
To Kate's Mountain Club.....	25c
To Airport.....	50c
To Skeet Club (at Airport).....	50c
To Polo Field.....	50c
To Village of White Sulphur Springs.....	25c
By the hour.....	\$5.00

For Special Trips inquire at Motor Service Office for rates.

**TEA:** Served during organ recitals at 4:30 in organ room.

**TELEGRAPH:** Western Union office, shop floor. Spring, Summer and Fall, open week days 8 a. m. to 10 p. m.; Sundays, 9 a. m. to 11 a. m. and 4 p. m. to 6 p. m. Winter Season—week days, 8:30 a. m. to 7:30 p. m.; Sundays, 9 a. m. to 10 a. m. and 5 p. m. to 6 p. m.

**TEMPERATURE:** During the Summer season a delightful average of 71 degrees prevails. Days are pleasantly warm and nights are cool. Yearly temperature, mean average 52.9 degrees. Temperature recorder on Front Portico of Greenbrier.

**TENNIS COURTS:** Adjoining Casino-Clubhouse. Five green Har-Tru (fast-drying) courts. Captain Valerian Yavorsky, tennis instructor. Court fees: 50c per hour, per person. Rackets for rent.

**TRAINED NURSE:** (Registered) Call Medical Department.

**TRAVEL AND INFORMATION BUREAU:** Shop floor. Miss Edith Barry, Manager. Open 9 a. m. to 5 p. m. daily, Spring, Summer, Fall and Winter. Sundays, 9 a. m. to 12 noon.

**TROPHY CASES:** In writing room adjoining north end of main lobby.

**VALET SERVICE:** Call Greenbrier Valet Department. Pressing, Alterations and Repairing on short notice. Zoric Odorless Dry Cleaning, one-day service. Special attention given Ladies' Garments.

**VIRGINIA ROOM:** In Virginia Row, south wing of Greenbrier. Contains murals by Wm. C. Grauer, depicting history of White Sulphur Springs.

## W

**WATERS OF WHITE SULPHUR SPRINGS:** Alvon, Sulphur, W. S. S. (concentrated), Greenbrier Sparkling Water and Greenbrier Ginger Ale are bottled and sold on the premises. Obtainable also in the Spring Room or through bell service. All waters also available for shipment. Call William Perry, manager of Water Department.

**WESTERN UNION:** Telegraph office, shop floor. Spring, Summer and Fall, open week days 8 a. m. to 10 p. m.; Sundays, 9 a. m. to 11 a. m. and 4 p. m. to 6 p. m. Winter Season, week days, 8:30 a. m. to 7:30 p. m.; Sundays, 9 a. m. to 10 a. m. and 5 p. m. to 6 p. m.

**WRITING ROOM:** Adjoining north end of main lobby, and also in Presidents' parlor.

## XYZ

**X-RAY DEPARTMENT:** Medical Department.

**PLEASE NOTE that opening and closing  
hours and prices are subject to  
change without notice**

### **SPECIAL TWO-WEEKS \$112.00 ALL-INCLUSIVE WINTER "REST HOLIDAY" RATE**

This special rate is \$112.00 (only \$8.00 per day) and is being offered from November 1 to April 1 to guests remaining for a two-weeks minimum visit. This All-Inclusive rate includes: Room with Private Bath, three excellent Meals a day, Swimming in the beautiful indoor pool; ALSO, guests on this rate may choose either the daily privilege of the famous Sulphur Bath or choose daily golf privileges (weather permitting). Guests must indicate their choice upon registration as the two privileges are not interchangeable from day to day. Whichever privilege is chosen will be included without charge as part of the \$112.00 All-Inclusive Rate while the other facility will be available at our special reduced Winter rates.

Information will be sent gladly upon request.

# Schedule of Annual Events

- Christmas Dance
- New Year's Eve Dance
- Governor's Ball.....February 22
- St. Patrick's Day Dance.....March 17
- Easter Sunday Egg Hunt
- Opening of Casino-Clubhouse for Luncheon-  
Dancing.....Early April through October
- Opening of Kate's Mountain Lodge for Luncheons, Teas,  
Dinners.....Early April through October
- Annual Mason and Dixon Men's Golf Tournament.....April
- Annual U. S. Open Tennis Championships.....April
- Annual West Virginia State Amateur Golf Championship  
(Closed, Men and Women).....July
- West Virginia State Open Tennis Championships  
(All 5 events).....July
- Annual West Virginia State Caddy Golf Championships.....July
- Opening of "Old White" Art School and Colony.....Middle of July
- Frequent picnics and barbecues are held throughout summer
- Putting contests are held often during summer
- Annual Virginias Seniors Men's Golf Championship.....August
- Annual "Old White" Music Festival Week.....Next to Last Week in August
- Annual "Old White" Men's Golf Tournament....Next to Last Week in August
- Annual Robert E. Lee Week—gala week of festivities....Last Week in August
- Annual Traveler's Round Robin Tennis Tournament....Last Week in August
- "Old White" Dahlia Show.....September
- Annual Mason and Dixon Women's Golf Championship.....August-September
- Annual Middle Atlantic Intercollegiate Tennis Doubles  
Championship.....Early October
- Halloween Dance
- Thanksgiving Party

